

# Technical Data - Rangemate

## Self-Priming Jet Pumps

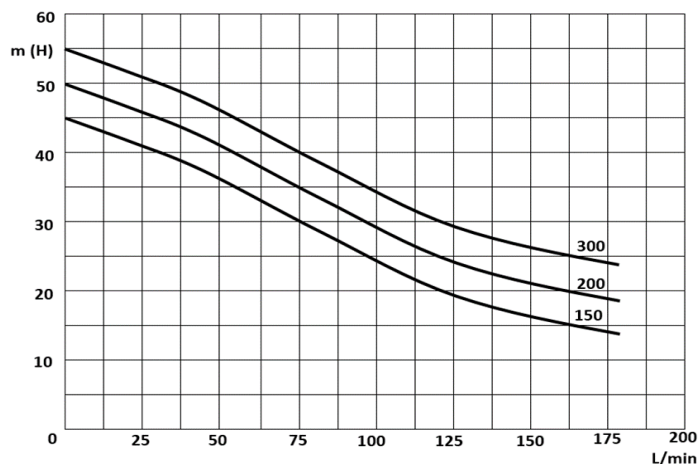

### CTJ2-150, 200 & 300



#### Description:

**CTJ2-150, 200 & 300:** This model features excellent hydraulic performance with considerably high suction and output pressure capacity, plus very low noise while running. Particularly suited for use in large domestic and agricultural irrigation jobs. It is recommended that these pumps are used to carry only chemically pure liquids (water) free of foreign matters, with a temperature not higher than 40°C. Monobloc horizontal axis pump with bronze Impeller, G20 cast iron pump body and base support, Venturi tube of Noryl with 20% glass fibre, AISI 416 stainless steel shaft and mechanical seal of ceramic/graphite. **Electric motors:** closed type with external cooling fan (TEFC), IP44 safety class. F insulation.

#### Specifications:

Model	Power					Speed rpm	Suction Max. (m)	Operating pressure Max. (kpa)	Package Dimensions			
	HP	kW	V	µf	A				L	H	W	Kg
CTJ2-150	1.5	1.1	240	31.5	9.3	2850	8	450	520	260	235	25.7
CTJ2-200	2	1.5	240	40	11.6	2850	8	500	520	260	235	27.8
CTJ2-300	3	2.2	240	45	12.5	2850	8	550	520	260	235	26.8

#### Construction:

Pump	Pump Body	Cast Iron
	Impeller	Noryl
	Mech. Seal	Ceramic / Graphite
	Pump Shaft	AISI 416
Motor	Motor Housing	Aluminium
	Motor Shaft	AISI 416
	Insulation	Class F
	Protection	IP44
	Cooling	External (TEFC)

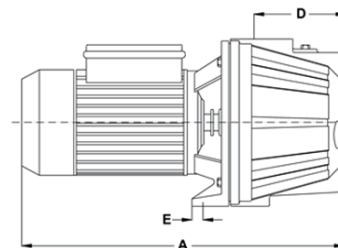
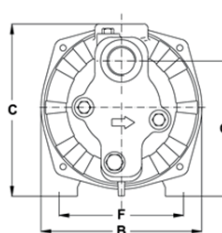

Model	Dimensions (mm)								Inlet	Outlet
	A	B	C	D	E	F	G			
CTJ2-150	510	210	220	166	18	166	165		1 1/2"	1'
CTJ2-200	510	210	220	166	18	166	165		1 1/2"	1'
CTJ2-300	510	210	220	166	18	166	165		1 1/2"	1'